

Features

- 6 3/8" spout wall to center
- 10.0 gpm (37.8 L/m) max flow rate
- Quick connect
- Solid brass construction
- Over 30 finishes including 15 PVD finishes

TS-E3-E3

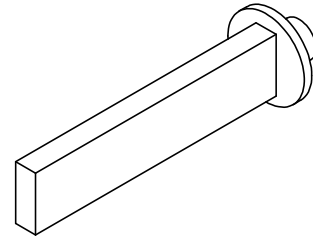

Codes/Standards Applicable

Meets or exceeds the following at date of manufacture:

- ASME A112.18.1/CSA B125.1

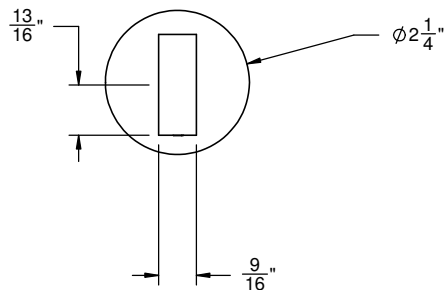
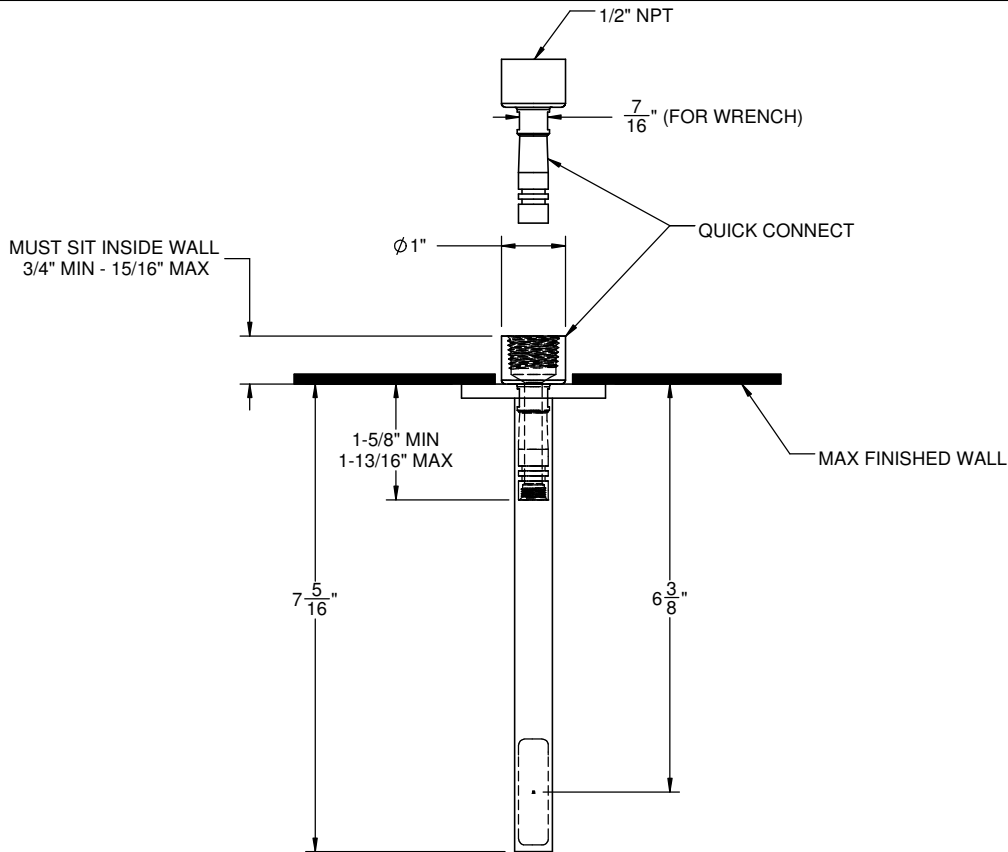

THROUGH-HOLE SPECIFICATIONS		
MIN	RECOMENDED	MAX
SPOUT: ϕ 1-1/4"	ϕ 1-1/4"	ϕ 1-5/8"

ALL DIMENSIONS SHOWN TO NEAREST 1/16"